

Lat: 36.006461 Lon: -84.179349 Zoom: 2.858 mi Logos are for identification purposes only and may be trademarks of their respective companies.

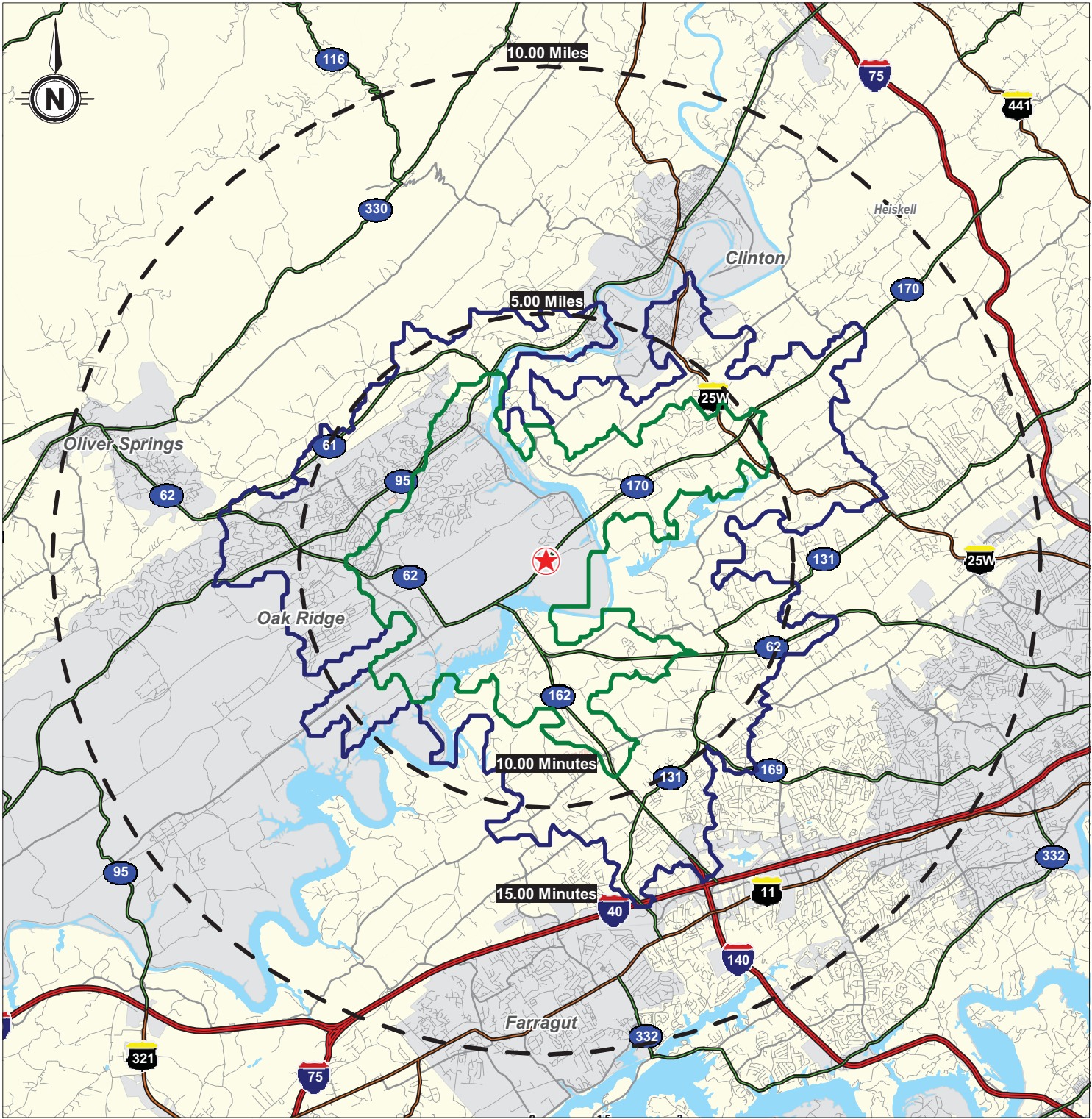

©2010, The Shopping Center Group, Nashville, TN (615) 259-0200. All Rights Reserved.

Centennial Village
Edgemoor Road at Park Meade Drive
Oak Ridge, Tennessee

Prepared For



Owner:
 Centennial Village Development, LLC
 John Chilton
 2 Weycliff Place
 Clinton, TN 37716
 Phone: (865) 388-9185
 Fax: (865) 463-8803

Parcels
 001101G A 00101
 001107H A 00100



For More Information: Parker Hardy, President/CEO | Oak Ridge Chamber of Commerce
 1400 Oak Ridge Turnpike, Oak Ridge, TN 37830 | (865) 483-1321 | hardy@orcc.org | www.orcc.org

This map was produced using data from private and government sources deemed to be reliable. The information herein is provided without representation or warranty.

Total Acres 117
Approximately 82 Useable Acres

110 ACRES
206 EDGEMOORE RD EDGEMOORE RD 206
CENTENNIAL VILLAGE

7 ACRES
206 EDGEMOORE RD EDGEMOORE RD 206
CENTENNIAL VILLAGE

EDGEMOORE RD

170

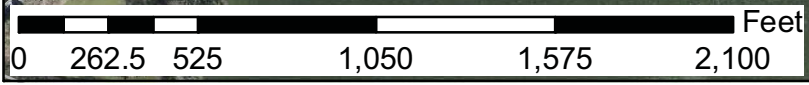

Total Acres 117
Approximately 82 Useable Acres

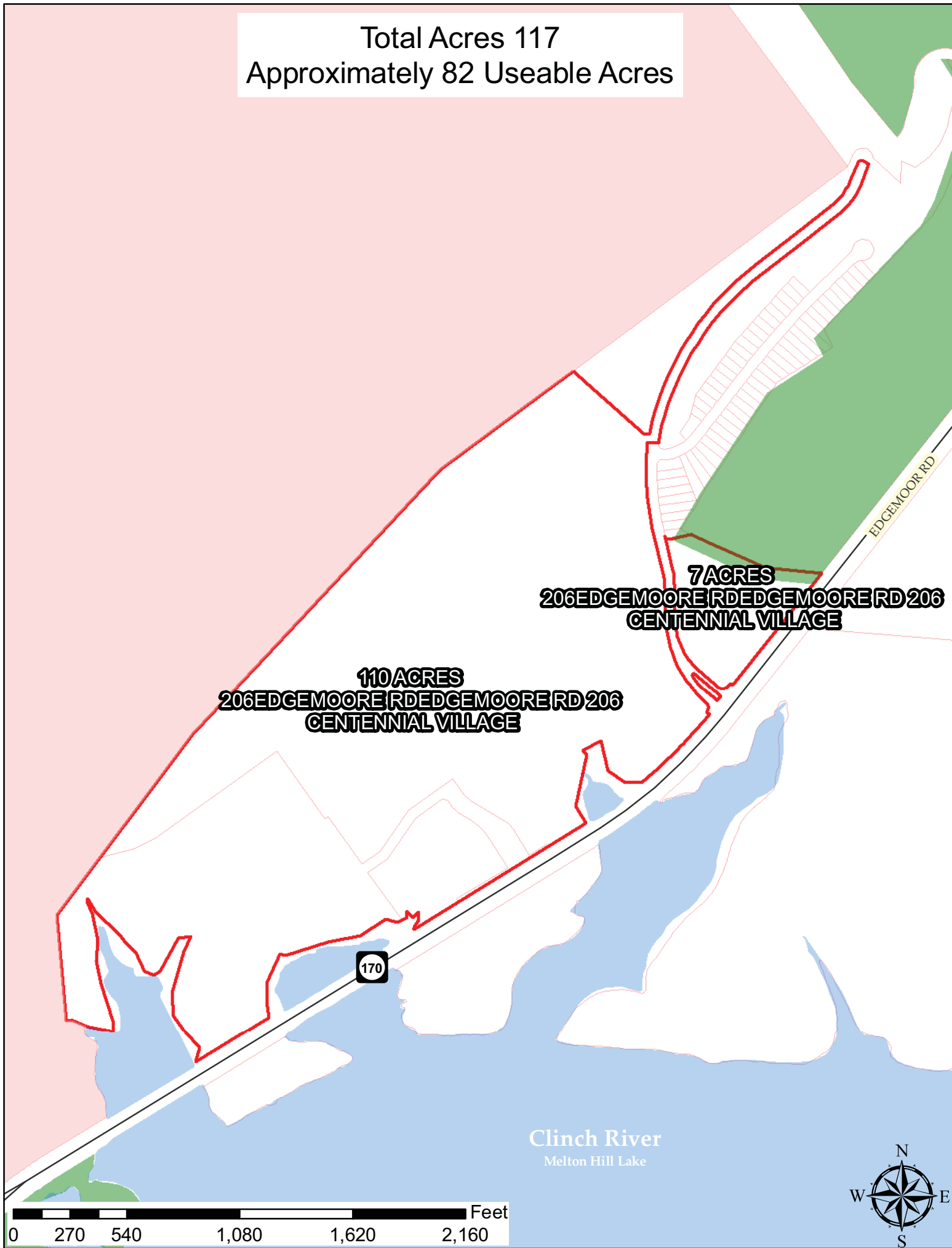

110 ACRES
206 EDGEMOORE RD EDGEMOORE RD 206
CENTENNIAL VILLAGE

7 ACRES
206 EDGEMOORE RD EDGEMOORE RD 206
CENTENNIAL VILLAGE

EDGEMOOR RD

170

Clinch River
Melton Hill Lake

0 270 540 1,080 1,620 2,160 Feet



SUMMARY DEMOGRAPHIC PROFILE

1990 - 2000 Census, 2010 Estimates & 2015 Projections - as of 1st Qtr / 10

Calculated using Proportional Blocks



Lat/Lon: 36.00646/-84.17935

2010

Edgemoor Road at Park Meade Drive Oak Ridge, Tennessee		5.00 mi radius	10.00 mi radius	10.00 min drivetime	15.00 min drivetime
POPULATION	2010 Estimated Population	43,155	205,558	16,071	59,256
	2015 Projected Population	46,018	215,302	17,073	63,141
	2000 Census Population	36,333	178,914	13,315	50,283
	1990 Census Population	33,045	151,719	11,952	44,739
	Historical Annual Growth 1990 to 2010	1.5%	1.8%	1.7%	1.6%
	Projected Annual Growth 2010 to 2015	1.3%	0.9%	1.2%	1.3%
	2010 Male Population	48.1%	48.2%	47.7%	48.1%
	2010 Female Population	51.9%	51.8%	52.3%	51.9%
	2010 Average Age	41.2	39.6	42.2	40.5
2010 Median Age	38.1	36.2	39.7	37.2	
HOUSEHOLDS	2010 Estimated Households	17,938	84,667	6,553	24,626
	2015 Projected Households	19,085	88,533	6,964	26,187
	2000 Census Households	15,256	73,807	5,448	20,982
	1990 Census Households	13,626	60,104	4,754	18,383
	Historical Annual Growth 1990 to 2010	1.6%	2.0%	1.9%	1.7%
Projected Annual Growth 2010 to 2015	1.3%	0.9%	1.3%	1.3%	
POPULATION BY RACE	2010 Estimated White	91.4%	91.0%	91.4%	91.1%
	2010 Estimated Black or African American	5.0%	5.0%	4.4%	5.3%
	2010 Estimated Asian	1.7%	2.2%	2.5%	1.8%
	2010 Estimated Other Races	1.8%	1.8%	1.7%	1.8%
	2010 Estimated Hispanic	2.3%	2.7%	2.4%	2.5%
INCOME	2010 Estimated Average Household Income	\$ 65,734	\$ 69,477	\$ 73,370	\$ 65,406
	2010 Estimated Median Household Income	\$ 55,089	\$ 58,155	\$ 62,180	\$ 54,627
	2010 Estimated Per Capita Income	\$ 27,580	\$ 28,786	\$ 30,545	\$ 27,266
EDUCATION (AGE 25+)	2010 Elementary	5.2%	4.5%	4.0%	5.0%
	2010 Some High School	9.3%	7.8%	8.5%	9.2%
	2010 High School Graduate	28.0%	25.8%	24.8%	27.4%
	2010 Some College	22.1%	22.2%	21.7%	22.3%
	2010 College Degree	35.5%	39.8%	41.1%	36.0%
BUSINESS	Number of Businesses	1,137	6,436	417	1,584
	Total Number of Employees	28,525	115,401	10,102	37,687
	Avg Employee Population per Business	25.1	17.9	24.2	23.8
	Avg Residential Population per Business	38.0	31.9	38.6	37.4

This report was produced using data from private and government sources deemed to be reliable. The information herein is provided without representation or warranty.